

SPECIFICATION

规范
 Rating: 50mA.12V DC
 额定值: 50mA.12V DC
 Insulation resistance: ≥100MΩ
 绝缘电阻: ≥100MΩ
 Dielectric strength: ≥250V AC 1 min
 抗电强度: ≥250V AC 1 min

Contact resistance: ≤100mΩ max
 接触电阻: ≤100mΩ max
 Travel: 0.20±0.1mm
 行程: 0.20±0.1mm
 Lifetime: 300000 times
 寿命: 300000 times

Height	
15	1.5MM
16	1.6MM
17	1.7MM

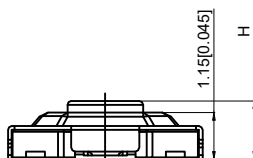
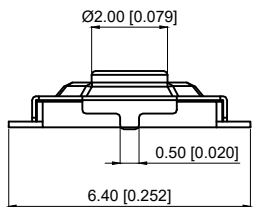

PCB. Welding board
PCB.焊接板

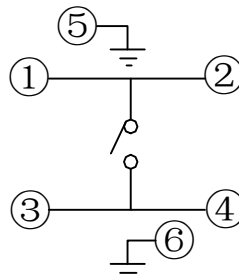

Circuit board
电路图

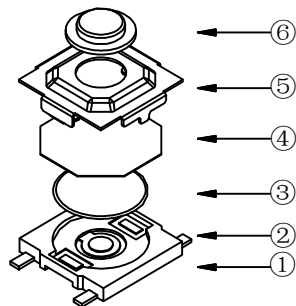

TP1642 □ □ □ □

Height

Actuation Force

16 : 160gf
 18 : 180gf
 26 : 260gf

6	Stem 按钮	Brass 黄铜	1	Acid pickling 酸洗
5	Cover plate 盖板	SUS	1	Clean 清洗
4	Dustproof film 防尘膜	Poly 聚酰亚胺	1	Orange 橙黄色
3	Shrapnel 弹片	SUS	1	Silvering 镀银
2	Essence 本体	LCP	1	Black 黑色
1	Card 卡件	Phosphor bronze 磷铜	1	Silvering 镀银
NO 序号	Part name 部件名	Material 材料	QTY 数量	Remark 备注

A4				
A3				
A2				
A1				
REV	DATE	REVISION	DESCRIPTION	ISSUE



COMMON TOLERANCE	
X.XX	± 0.10
X.X	± 0.15
X	± 0.25
ANGULAR	—

UNIT	MM	PROJECTED		PRODUCT NAME: TP1642 □ □ □ □
DRAWN BY	SHUHAO	CHECKED BY	COCO	MODEL NO:
DATE	2019	APPROVAL B	ALEN	Https: www.rocpcu.tw
ROCPCU TECHNOLOGY CO.,LTD				
Copies are issued in strict confidence and shall not be reproduced or copied, or used as the basic of manufacture or sale of apparatus without permission				