

PCB . LAYOUT

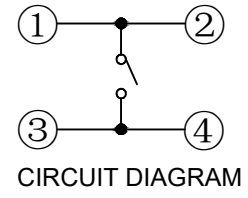
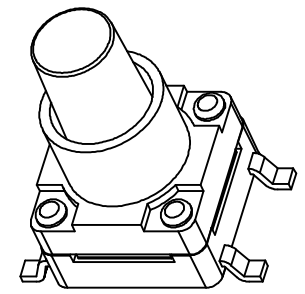
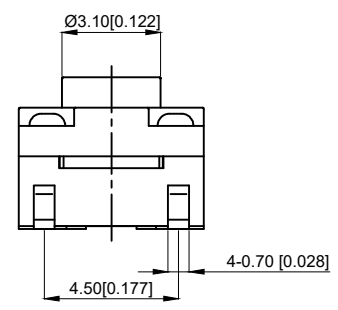
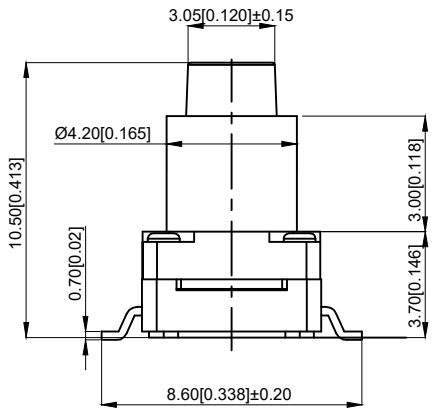

CIRCUIT DIAGRAM

NOTES:

1. Rating: 12VDC 50mA
1. 额定值: 12VDC 50mA
2. Dielectric Strength: 250V AC
2. 耐电压: 250V AC
3. Contact Resistance: ≤100mΩ Max
3. 接触电阻: ≤100mΩ
4. Insulation Resistance: ≥100MΩ
4. 绝缘电阻: ≥100MΩ
5. Operating Force: 260±50gf
5. 操作力: 260±50gf
6. Life: 200,000 times
6. 寿命: 200,000 times
7. Travel: 0.25±0.10mm
7. 行程: 0.25±0.10mm
8. Water Resistance: IP67
8. 耐水性: IP67
9. Operating Temperature Range: -20°C~70°C
9. 使用温度: -20°C~70°C

6	Stem 柄	PA6T	1	Black 黑色
5	COVER 盖板	PA6T	1	Black 黑色
4	Tape 胶带	SILICONE RUBBER	1	Black 黑色
3	Shrapnel 弹片	SUS	1	Ag plating 镀银
2	Terminal 端子	Brass	1	Ag plating 镀银
1	Base 底座	PA6T	1	Black 黑色
NO 序号	Part name 部件名	Material 材料	QTY 数量	Remark 备注

A4				
A3				
A2				
A1				
REV	DATE	REVISION	DESCRIPTION	ISSUE



COMMON TOLERANCE	
X.XX	± 0.10
X.X	± 0.15
X	± 0.25
ANGULAR	—

UNIT	MM	PROJECTED		PRODUCT NAME:
DRAWN BY	FUYUAN	CHECKED BY	COCO	MODEL NO: TP152226105
DATE	2019	APPROVAL B	ALEN	Https: www.rocpcu.tw

ROCPCU TECHNOLOGY CO.,LTD

Copies are issued in strict confidence and shall not be reproduced or copied, or used as the basic of manufacture or sale of apparatus without permission