

P.C.B LAND DIMENSION

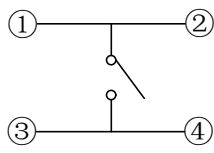
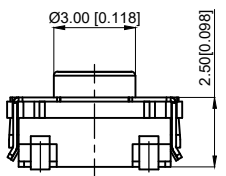
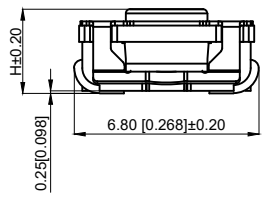

CIRCUIT DIAGRAM

- 1. Maximum rating: 50mA 12V DC
- 1.最大额定值: 50mA 12V DC
- Minimum rating: 10µA 1V DC
- 最小额定值: 10µA 1V DC
- 2. Insulation resistance: ≥ 100M Ω
- 2.绝缘电阻: ≥100MΩ
- 3. Contact resistance: ≤ 100m Ω
- 3.接触电阻: ≤100mΩ
- 4. Withstand voltage: 250V AC
- 4.耐压: 250V AC
- 5. Operating temperature: -20 °C ~ +70 °C
- 5.使用温度: -20°C ~ +70°C
- 6. Service life: 1,000,000 times
- 6.寿命: 1,000,000次
- 7. Stroke: 0.35 ± 0.10mm
- 7.行程: 0.35±0.10mm

TP1112 □ □ □ □

Height
Actuation Force
16 : 160gf
26 : 260gf
35 : 350gf

Height	
31	3.1MM
35	3.5MM
40	4.0MM
43	4.3MM
45	4.5MM
51	5.1MM

6	Terminal 端子	BASS 黄铜	4	Ag plating 镀银
5	Housing 外壳	SUS	1	
3	Handle 按柄	silica gel 硅胶	1	Blue 蓝色
2	Shrapnel 弹片	SUS	1	Ag plating 镀银
1	Base 基座	PA46	1	Black 黑色
NO 序号	Part name 部件名	Material 材料	QTY 数量	Remark 备注

A4				
A3				
A2				
A1				
REV	DATE	REVISION	DESCRIPTION	ISSUE



COMMON TOLERANCE	
X.XX	± 0.10
X.X	± 0.15
X	± 0.25
ANGULAR	—

UNIT	MM	PROJECTED		PRODUCT NAME: TP1112 □ □ □ □
DRAWN BY	SHUHAO	CHECKED BY	COCO	MODEL NO:
DATE	2019	APPROVAL B	ALEN	Https: www.rocpcu.tw
ROCPCU TECHNOLOGY CO.,LTD				
Copies are issued in strict confidence and shall not be reproduced or copied, or used as the basic of manufacture or sale of apparatus without permission				