

Technical parameter  
技术参数

- Rated current: 100mA 30V DC  
1. 额定电流: 100mA 30V DC
- Contact resistance:  $\leq 10 \Omega$   
2. 接触电阻:  $\leq 10 \Omega$
- Operating force: 260gf  $\pm$  50gf  
3. 操作力: 260gf  $\pm$  50gf
- Maximum stroke: 3.0  $\pm$  0.2mm  
4. 最大行程: 3.0  $\pm$  0.2mm

- 最大行程: 3.0  $\pm$  0.2mm
- Insulation resistance:  $\geq 100M \Omega$   
5. 绝缘电阻:  $\geq 100M \Omega$
- Electric strength: AC250V 50Hz 1min  
6. 抗电强度: AC250v 50Hz 1Min
- 抗电强度: AC250v 50Hz 1Min
- Service life: 10000 times  
7. 寿命: 10000次

BTSA-□-P-15

Operation  
L : self-locking  
N : lock-free

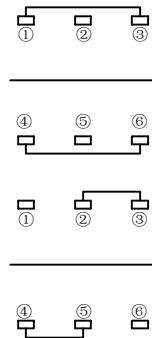
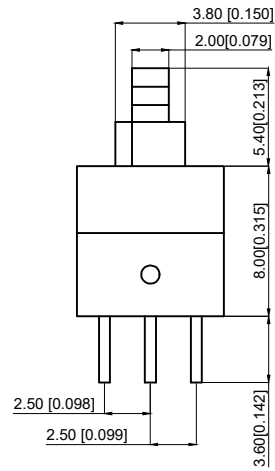
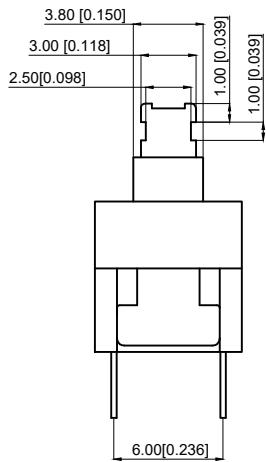

常态: 1-3导通 4-6导通  
按下: 2-3导通 4-5导通

7	crochet hook 钩针	SUS 不锈钢丝	1	Natural color 本色
6	Spring 弹簧	SUS 不锈钢丝	1	Natural color 本色
5	reed 簧片	Composite silver 复合银	1	Natural color 本色
4	Upper cover 上盖	PPA	1	black 黑色
3	handle 按柄	PA66 尼龙66	1	black 黑色
2	terminal 端子	Brass 黄铜	1	Natural color/silver 本色/镀银
1	Pedestal 基座	PPA	1	black 黑色
ITEM	Name	Materials	NUM	COLOR

A4				
A3				
A2				
A1				
REV	DATE	REVISION	DESCRIPTION	ISSUE



COMMON TOLERANCE	
X.XX	$\pm 0.10$
X.X	$\pm 0.15$
X	$\pm 0.25$
ANGULAR	—

UNIT	MM	PROJECTED		PRODUCT NAME: BTSA-□-P-15
DRAWN BY	SHUHAO	CHECKED BY	COCO	MODEL NO:
DATE	2019	APPROVAL B	ALEN	Https: <a href="https://www.rocpcu.tw">www.rocpcu.tw</a>
<b>ROCPCU TECHNOLOGY CO.,LTD</b>				
Copies are issued in strict confidence and shall not be reproduced or copied, or used as the basic of manufacture or sale of apparatus without permission				