

PCB.安装尺寸图

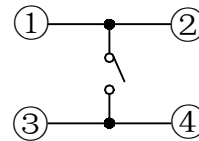

电路原理图

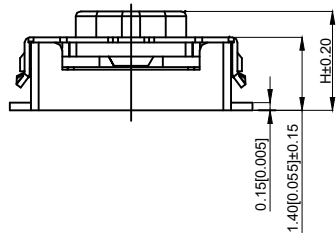
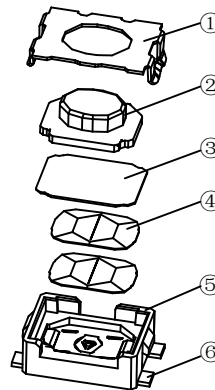

NOTES:

- 1.Rating:DC 32V 50mA
- 1.额定值: DC 32V 50mA
- 2.Dielectric Strength:250V AC
- 2.耐电压: 250V AC
- 3.Contact Resistance:≤100mΩ Max
- 3.接触电阻: ≤100mΩ
- 4.Insulation Resistance:≥100MΩ
- 4.绝缘电阻: ≥100MΩ

- 5.Life: 100,000 times
- 5.寿命: 100,000 次
- 6.Travel: 0.20±0.1mm
- 6.行程: 0.20±0.1mm
- 7.Operating temp: -40℃~85℃
- 7.使用温度: -40℃~85℃
- 8.Protection grade: IP65
- 8.防水等级: IP65

TP1452 □ □ □ □
 Height
 19:1.9MM
 Actuation Force
 20 : 200gf
 30 : 300gf

6	Terminal 端子	Brass	1	Ag plating 镀银
5	Pedestal 基座	PA6T	1	Black 黑色
4	Shrapnel 弹片	SUS	2	Silver coated
3	Tape 防尘胶	Gathers the Imide	1	Yellow 黄色
2	Button 按钮	PPA	1	Black 黑色
1	Cover 盖板	SUS	1	
NO 序号	Part name 部件名	Material 材料	QTY 数量	Remark 备注

A4				
A3				
A2				
A1				
REV	DATE	REVISION	DESCRIPTION	ISSUE



COMMON TOLERANCE	
X.XX	± 0.10
X.X	± 0.15
X	± 0.25
ANGULAR	—

UNIT	MM	PROJECTED		PRODUCT NAME: TP1452 □ □ □ □
DRAWN BY	SHUHAO	CHECKED BY	COCO	MODEL NO:
DATE	2019	APPROVAL B	ALEN	Https: www.rocpcu.tw
ROCPCU TECHNOLOGY CO.,LTD				
Copies are issued in strict confidence and shall not be reproduced or copied, or used as the basic of manufacture or sale of apparatus without permission				