

PCB LAYOUT TOP VIEW

Technical parameter
 技术参数
 1. Rated current: 100mA 30V DC
 1. 额定电流: 100mA 30V DC
 2. Contact resistance: ≤200mΩ
 2. 接触电阻: ≤200mΩ
 3. Operating force: 250 ± 50gf
 3. 操作力: 250±50gf

4. Maximum travel: 2.0±0.2mm
 4. 最大行程: 2.0±0.2mm
 5. Insulation resistance: ≥100mΩ
 5. 绝缘电阻: ≥100mΩ
 6. Life: 10000次
 6. 寿命: 10000次

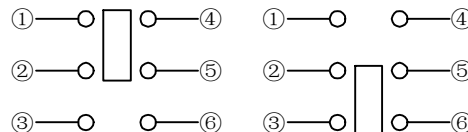
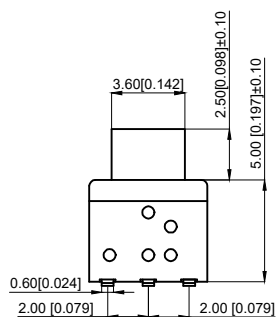

Circuit diagram
 Normal: 1-2 on 4-5 on
 Press: 2-3 on 5-6 on

BTSA-□-S-8

Operation
 L : self-locking
 N : lock-free

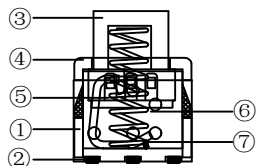
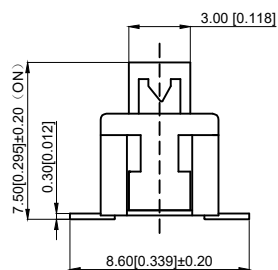

7	Crochet hook 钩针	SUS 不锈钢	1	
6	Spring 弹簧	SUS 不锈钢	1	
5	Contact Spring 接触弹片	Compound silver 复合银	1	
4	Upper Cover 上盖	PPA	1	Black 黑色
3	Handle 按柄	PA6T	1	White 白色
2	Terminal 端子	Brass 黄铜	1	Ag-Plated 镀银
1	Pedestal 基座	PPA	1	Grey 灰色
NO 序号	Part name 部件名	Material 材料	QTY 数量	Remark 备注

A4				
A3				
A2				
A1				
REV	DATE	REVISION	DESCRIPTION	ISSUE



COMMON TOLERANCE	
X.XX	± 0.10
X.X	± 0.15
X	± 0.25
ANGULAR	—

UNIT	MM	PROJECTED	PRODUCT NAME: BTSA-□-S-8
DRAWN BY	SHUHAO	CHECKED BY	COCO
DATE	2019	APPROVAL B	ALEN
ROCPCU TECHNOLOGY CO.,LTD Copies are issued in strict confidence and shall not be reproduced or copied, or used as the basis of manufacture or sale of apparatus without permission.			

MODEL NO:
 https: www.rocpcu.tw