

电路图
CIRCUIT DIAGRAM

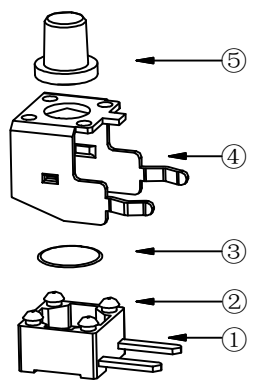

NOTES:

- 1. Rate voltage : 50mA DC12V
- 1. 额定电压 : 50mA DC12V
- 2. Contact resistance: ≤100mΩ
- 2. 接触电阻 : ≤100mΩ
- 3. Travel: 0.20±0.10mm
- 3. 行程 : 0.20±0.10mm

- 4. Insulated resistance: ≥100mΩ
- 4. 绝缘电阻 : ≥100mΩ
- 5. Dielectric strength: ≥250VAC
- 5. 介电强度 : ≥250VAC
- 6. life: 50000times
- 6. 寿命 : 50000次
- 7. Working temperature: -20℃~80℃
- 7. 工作温度 : -20℃~80℃

TP1261 □ □ □ □

Height
Actuation Force
16 : 160gf
26 : 260gf

Height	
43	4.3MM
50	5.0MM

5	Push-button 按钮	PPA	1	Black 黑色
4	Blind flange 盖板	Cutter	1	Copper tin plating 镀铜锡
3	Shrapnel 弹片	SUS	1	Ag plating 镀银
2	Noumenon 本体	PPA	1	Black 黑色
1	Card 卡件	Brass	1	Ag plating 镀银
NO 序号	Part name 部件名	Material 材料	QTY 数量	Remark 备注

A4				
A3				
A2				
A1				
REV	DATE	REVISION	DESCRIPTION	ISSUE



COMMON TOLERANCE	
X.XX	± 0.10
X.X	± 0.15
X	± 0.25
ANGULAR	
	—

UNIT	MM	PROJECTED		PRODUCT NAME: TP1261 □ □ □ □
DRAWN BY	SHUHAO	CHECKED BY	COCO	MODEL NO:
DATE	2019	APPROVAL B	ALEN	Https: www.rocpcu.tw
ROCPCU TECHNOLOGY CO., LTD				
Copies are issued in strict confidence and shall not be reproduced or copied, or used as the basic of manufacture or sale of apparatus without permission				